

FLAT MOTORS

PRT 100 SERIES - Reversible

WATT: 320 / CONSUMPTION: 900 NI/min

Data sheet
PRT 100R

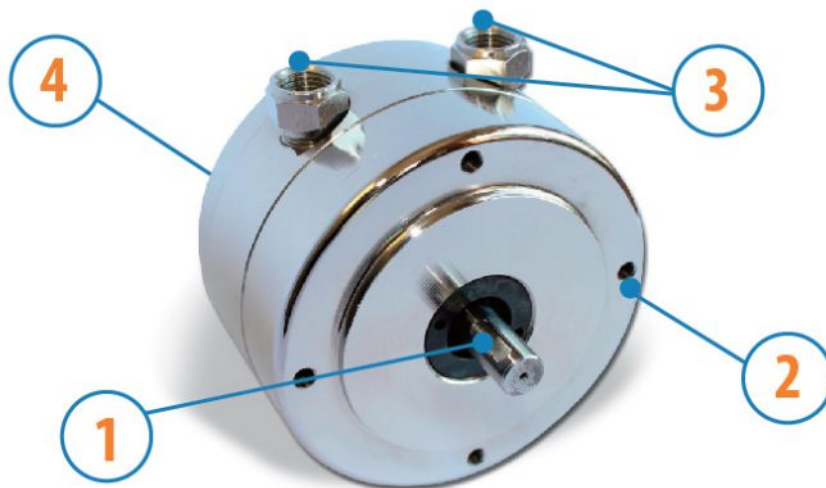

1. Cylindrical keyed shaft
2. Holes for fixing in compliance with electric motors B14 size 71 UNEL
3. Air inlets
4. Air exhaust

Technical specification

- Model	PRT 100R
- Code	8907241
Speed rpm - No-load	3000
Speed rpm - at Max Power	1820
Torque Nm - at Max Power	1,7
Torque Nm - Stall Torque	3,6

Form features

The normal delivery condition of the models listed in the table is that with cylindrical shaft and body as shown in the photo.

BODY

- The front is envisaged to couple to the flanges or other parts of the machine, conforming to the standard flange Type B14 size 71 UNEL.

Characteristic curves

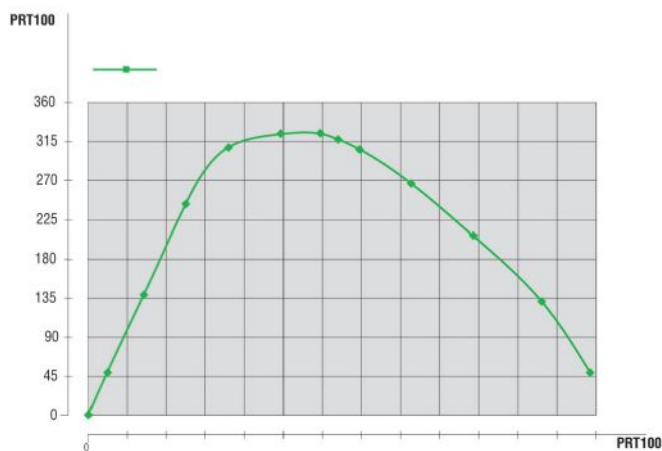
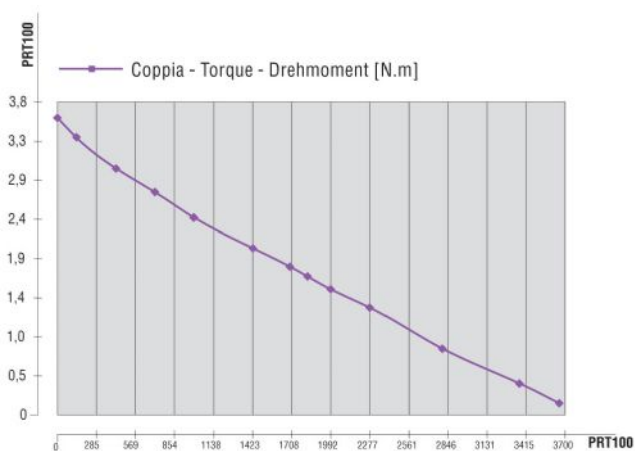

FLAT MOTORS

PRT 100 SERIES - Reversible

WATT: 320 / CONSUMPTION: 900 NI/min

Data sheet
PRT 100R

Permissible radial and axial loads

Model	Code	Fr (N)	Fa (N)	Co (N)
PRT 100R	8907241	1397	980	1960

Overall dimensions

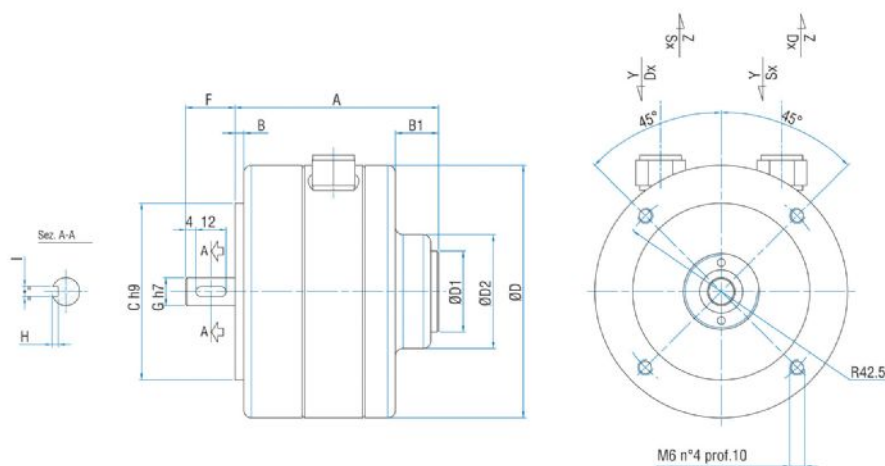

Fori per fissaggio conformi a motori elettrici
Tipo B14 grandezza 71 UNEL
Fixing holes in conformity with electric motors
Type B14 size 71 UNEL
Löcher zur befestigung mit Elektromotoren
Type B14 grösse 71 UNEL einzuhalten

Model	Code	A	B	B1	C	D	D1	D2	F	G	H	I	Y	Z
PRT 100R	8907241	81	3,5	17	70	100	32	45	19,5	11	2,5	4	1/4"	1/4"